

Preload Grade

| Series | Preload grade | | |
|--------|--------------------|---------------------|--------------------|
| | Light preload (FC) | Medium preload (F0) | Heavy preload (F1) |
| MSB15T | 0~0.02C | 0.03~0.05C | - |
| MSB20T | | | |
| MSB25T | | | |
| MSB30T | | | 0.05~0.08C |
| MSB15 | 0~0.02C | 0.03~0.05C | 0.05~0.08C |
| MSB20 | | | |
| MSB25 | | | |
| MSB30 | | | |
| MSB35 | | | |
| MSB35L | | | |

Note: C is basic dynamic load rating in above table. Refer to the specification of products, please.

The Shoulder Height and Corner Radius for Installation

MSB series

Unit: mm

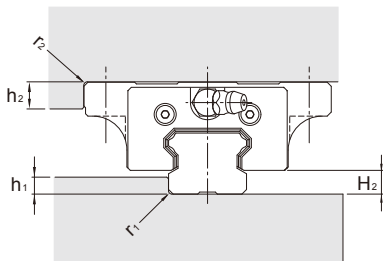

| Model No. | r_1 (max.) | r_2 (max.) | h_1 | h_2 | H_2 |
|-----------|--------------|--------------|-------|-------|-------|
| 15 | 0.5 | 0.5 | 3 | 4 | 4.5 |
| 20 | 0.5 | 0.5 | 4 | 5 | 6 |
| 25 | 1 | 1 | 5 | 5 | 7 |
| 30 | 1 | 1 | 7 | 5 | 9.5 |
| 35 | 1 | 1 | 8 | 6 | 9.5 |